

Curved Cantilever Display

Product Parts

- 1 - Base
- 2 - Curved Horizontal Pole
- 3 - Upper Telescoping Support Pole
- 4 - Lower Telescoping Support Pole
- 5 - Large Key Bolt
- 6 - Small Key Bolt
- 7 - Base Hex Bolt
- 8 - Hex Wrench

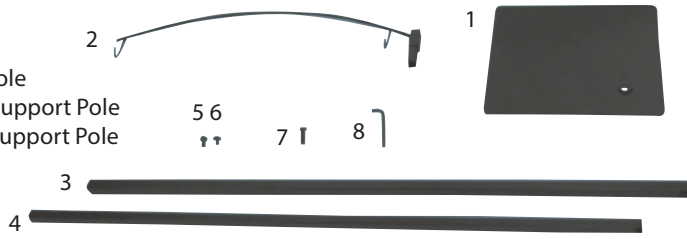

Display Set-Up

Step 1

Begin assembly by removing the display from its box and placing it on a clean flat surface. Position both sections of the Telescoping Support Pole (3,4) so that the threaded receptacles are aligned on the same side.



Fully Insert the Upper Telescoping Support Pole (3) into the Lower Telescoping Support Pole (4).

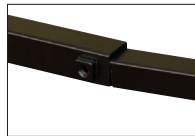

Step 3

To install the Base (1), stand it upright on its edge with the threaded hole in the lower corner. Lift the Lower Telescoping Support Pole (4) and insert the raised area of the base plate into the recess of the Lower Telescoping Support Pole (4).

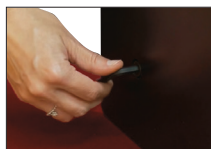

Thread the Base Hex Bolt (7) through the hole in the bottom of the Base (1) and turn clockwise with the Hex Wrench (8) until fully secure.

Step 5

To display your grommeted graphic, simply insert the display's hooks into the graphic's grommet holes and allow the graphic to hang freely.



Step 2

(A) Thread the Large Key Bolt (5) into the Lower Telescoping Support Pole (4) stopping before it touches the Upper Telescoping Support Pole (3).

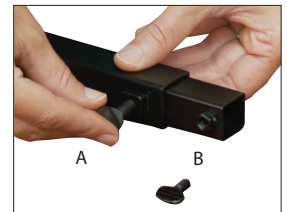

(B) Thread the Small Key Bolt (6) a few turns into the Upper Telescoping Support Pole's (3) receptacle stopping just as it extends into the pole cavity.

Step 4

Place the display upright on the floor.

Insert the support section of the Curved Horizontal Pole (2) into the top of the Upper Telescoping Support Pole (3) and turn the Small Key Bolt (6) clockwise until fully secure.



Lift the Upper Telescoping Support Pole (3) upwards to your desired height and secure in place by turning the Large Key Bolt (5) clockwise until secure.

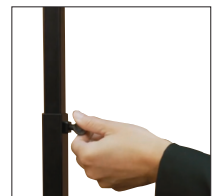

****Note:** If needed, pull up on the end of the Curved Horizontal Pole (2) until the graphic hangs level

Storage

Store in a cool dry location.

Care

To clean, wipe with damp cloth.